

PRODUCT 101 | BOOTHS

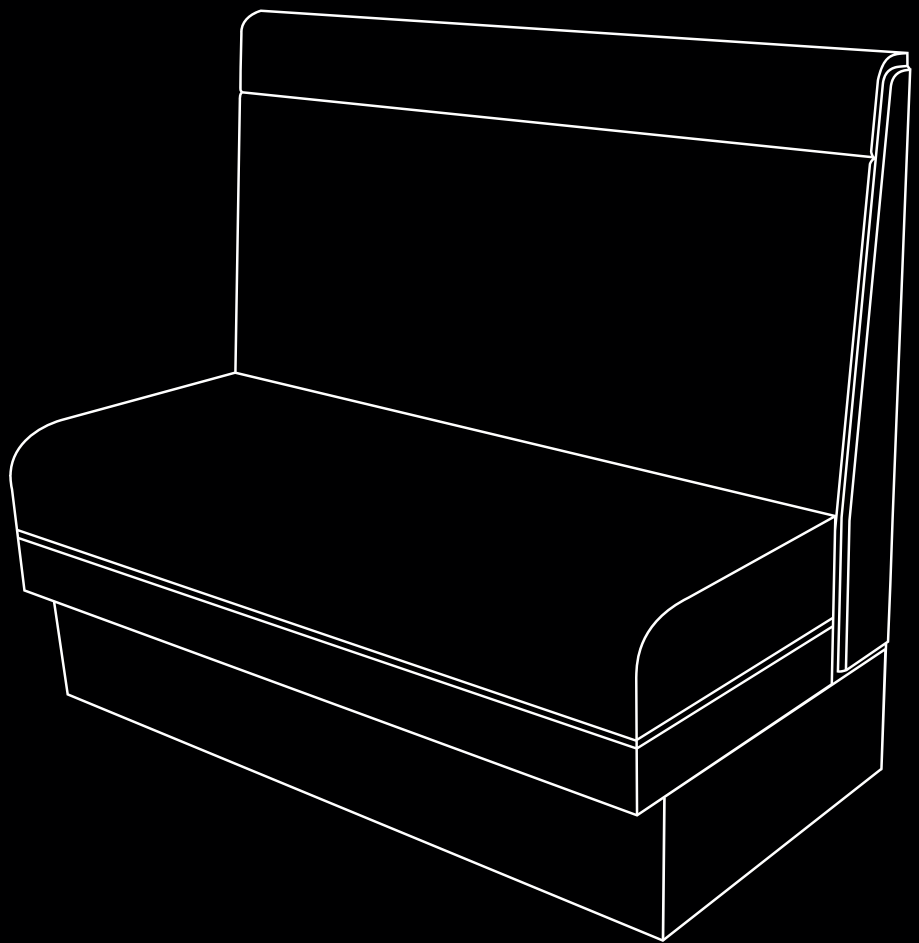

UPHOLSTERED BOOTHS

THE DIFFERENCE IS IN THE DETAILS.

- 1 3/4" PLYWOOD CONSTRUCTION**
UNLIKE COMPETITORS THAT USE 1/2" THICK PLYWOOD OR EVEN MEDIUM DENSITY FIBERBOARD (MDF), EVERY COMPONENT OF OUR BOOTH IS MADE WITH 3/4" PLYWOOD THAT HELPS TO PROVIDE LONG LASTING STRENGTH AND DURABILITY.
- 2 8 GAUGE ZIGZAG SPRINGS**
THICKER THAN INDUSTRY STANDARD SPRINGS, OUR 8 GAUGE STEEL SPRINGS ARE SPACED AT TIGHT INTERVALS, CREATING A FIRM, NON SAGGING SEAT.
- 3 HEAVY DUTY STEEL "C" CLIPS**
OUR HEAVY DUTY STEEL "C" CLIPS ARE USED TO ENSURE THAT THE SPRINGS RETAIN THEIR TENSION AND ARE SECURELY FASTENED TO THE SEAT FRAME.
- 4 INTERWOVEN SUPPORT STRIPS**
WE INTERWEAVE SUPPORT STRIPS TO EVENLY DISTRIBUTE WEIGHT AND TENSION ON THE SPRINGS AND GIVE A MORE BALANCED FEEL AND UNIFORM RESISTANCE.
- 5 SUB LAYER**
IMMEDIATELY FOLLOWING OUR INTERWOVEN SUPPORT STRIPS, IS A SUB LAYER MADE OF OUR HEAVY DUTY VINYL THAT ACTS AS A BARRIER TO PROTECT THE HIGH DENSITY FOAM FROM ANY WEAR THAT THE SPRINGS MAY CAUSE DUE TO MOVEMENT.
- 6 HIGH RESILIENCE EXTRA FIRM FOAM (HR50)**
OUR FOAM IS DENSER THAN MOST INDUSTRY STANDARD FOAMS USED IN BOOTH CONSTRUCTION. WE USE BETTER FOAM NOT ONLY FOR COMFORT AND INTEGRITY, BUT TO INCREASE THE OVERALL LONGEVITY OF THE SEAT.
- 7 PLUSH FOAM BATTING**
WE ADD AN EXTRA LAYER OF PADDING THAT HELPS TO CREATE AN EVEN SMOOTHER SEAT.
- 8 TOUGH VINYL**
ALL OF OUR BOOTHS HAVE A MINIMUM 100K-200K DOUBLE-RUB VINYL OR SIMILAR MATERIAL ON THE SEAT, BACK, AND BASE TO HELP WITHSTAND CONSTANT CUSTOMER USE.
- 9 REMOVABLE SEAT**
WE ENGINEER OUR SEATS TO SET FIRMLY IN PLACE, BUT ALSO TO BE REMOVED IF NEEDED, MAKING CLEANING AND THE OPTION OF FUTURE REUPHOLSTERY EASIER.
- 10 REINFORCED PLYWOOD FRAME**
OUR STURDY BASE USES 3/4" PLYWOOD WITH REINFORCED CORNER BRACING THAT IS GLUED AND NAILED IN PLACE TO GIVE THE BASE AN ADDED LAYER OF RIGIDITY. OUR 100,000 DOUBLE-RUB BLACK VINYL IS USED ON THE BASE TO HELP RESIST DAILY WEAR. (OPTION TO PAINT THE BASE IS ALSO AVAILABLE)

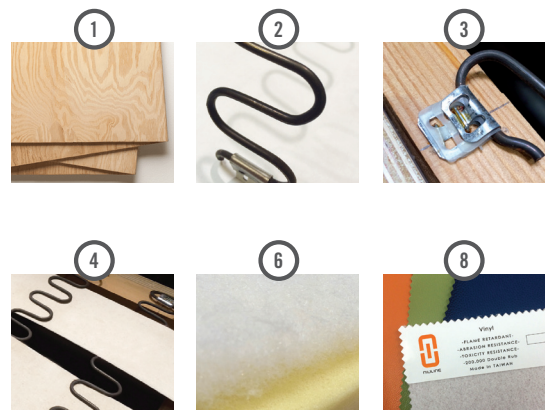

*VINYL COVERED END PANELS NOT SHOWN ON CUT-AWAY

BOOTH STYLES

THE DIFFERENCE IS IN THE DETAILS.

- ① **BASIC BOOTH**
FLAT BACK, NO HEADROLL,
NO CHANNELS
- ② **BASIC BOOTH WITH HEADROLL**
FLAT BACK, HORIZONTAL HEADROLL
- ③ **WELT BACK BOOTH**
TWO OR MORE WELT PANELS
ON BACK, HORIZONTAL HEADROLL
- ④ **HORIZONTAL CHANNEL BOOTH**
UP TO 4 HORIZONTAL CHANNELS
ON BACK
- ⑤ **VERTICAL CHANNEL BOOTH**
UP TO SIX VERTICAL CHANNELS
ON BACK
- ⑥ **ARCHED BACK BOOTH**
FLAT BACK, ARCHED BACK AND
HEADROLL
- ⑦ **CUSTOM TRIMMED HEADROLL BOOTH**
FLAT BACK, CUSTOM TRIMMED
HEADROLL
- ⑧ **TALL BACK BOOTH**
MULTIPLE PANELS, TALLER THAN
STANDARD 42" BOOTH
- ⑨ **TUFTED BOOTH**
DIAMOND BUTTON OR STRAIGHT
LINE BUTTON TUFTING
- ⑩ **WALL MOUNTED BOOTH**
BACK MOUNTED TO WALL, SEAT BOX ON
GROUND AGAINST WALL

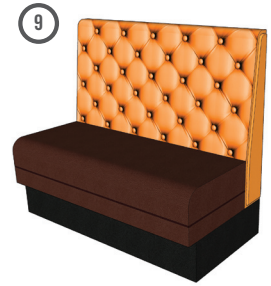
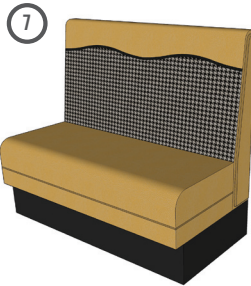

BOOTH NOMENCLATURE/MEASUREMENTS

THE DIFFERENCE IS IN THE DETAILS.

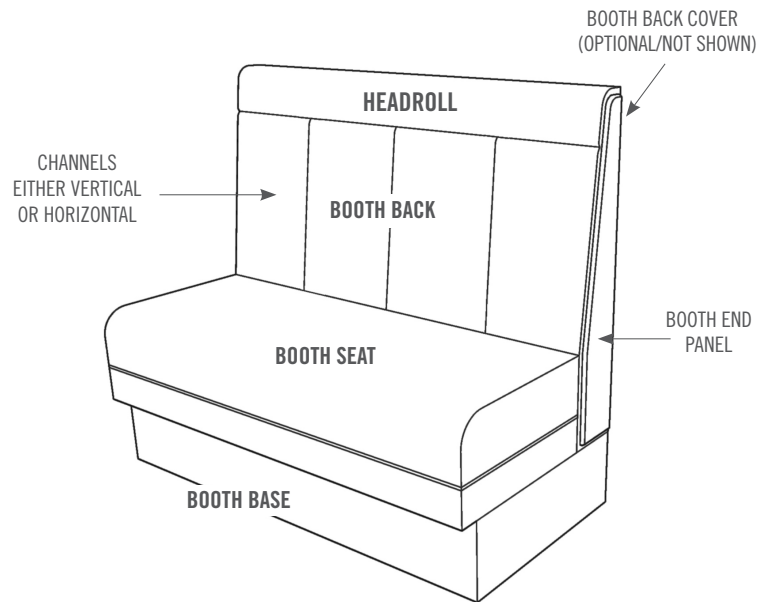

STANDARD 42" HEIGHT, SINGLE BOOTH
TYPICAL MEASUREMENTS

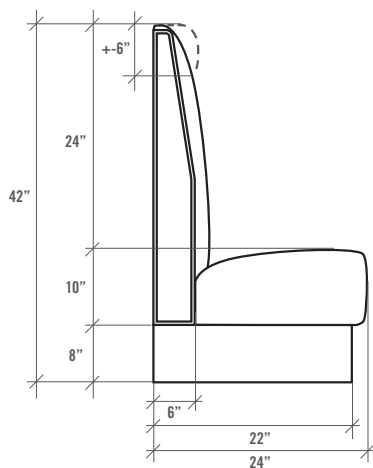

STANDARD 42" HEIGHT, DOUBLE BOOTH
TYPICAL MEASUREMENTS

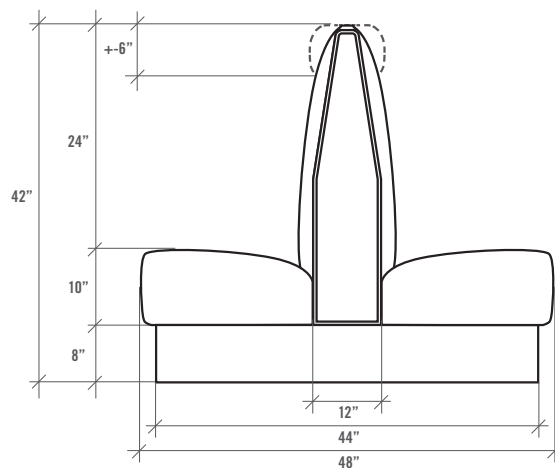

WALL MOUNTED BOOTH
TYPICAL MEASUREMENTS

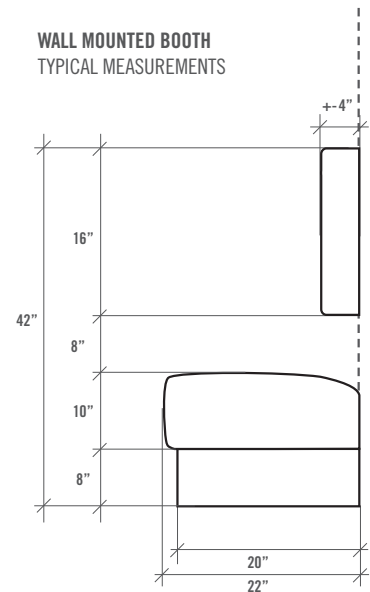

BOOTH CONFIGURATIONS

THE DIFFERENCE IS IN THE DETAILS.

- 1 SINGLE AND DOUBLE BOOTHS**
 STANDARD LENGTHS: 48" AND 60"
 CUSTOM LENGTH: 30", 72"
 HEIGHT: UP TO 42"*
 SEATS APPROX. 1 PERSON PER 24"
- 2 BENCH BOOTHS**
 STANDARD LENGTHS: ANY LENGTH AS NEEDED
 CUSTOM LENGTH: ANY LENGTH AS NEEDED, MAY BE CURVED
 HEIGHT: UP TO 42"
 SEATS APPROX. 1 PERSON PER 24"
- 3 THREE QUARTER CIRCLE BOOTHS**
 STANDARD DIMENSIONS: 48" X 90" X 90" X 48"
 CUSTOM LENGTH: ANY LENGTH AS NEEDED
 HEIGHT: UP TO 42"*
 SEATS: 4-6
- 4 HALF CIRCLE BOOTHS**
 STANDARD DIMENSIONS: 48" X 90" X 48"
 CUSTOM LENGTH: ANY LENGTH AS NEEDED
 HEIGHT: UP TO 42"*
 SEATS: 2-4

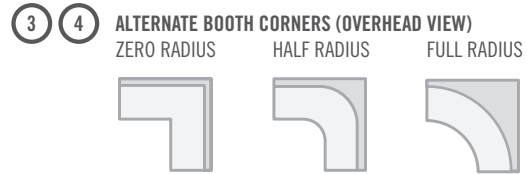
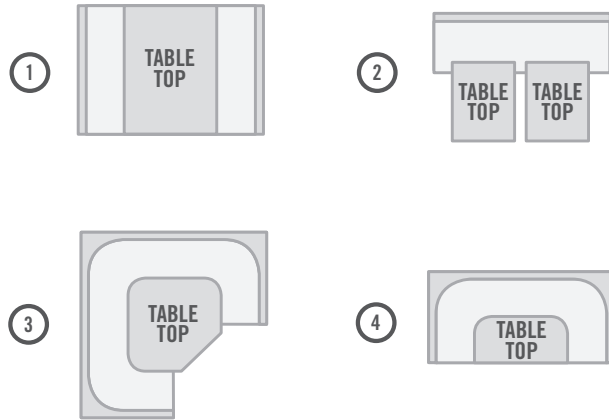

CUSTOM
 NIULINE CAN BUILD MOST ALL BOOTH DESIGNS WITH PROPER PLANS, ELEVATIONS, AND CALL-OUTS.

*TYPICAL RESTAURANT BOOTH HEIGHT IS 42"

BOOTH CONFIGURATIONS

THE DIAGRAM BELOW SHOWS HOW YOU CAN PUT TOGETHER VARIOUS BOOTH SHAPES WITHIN A SPACE TO CREATE AN EFFICIENT SEATING PLAN.

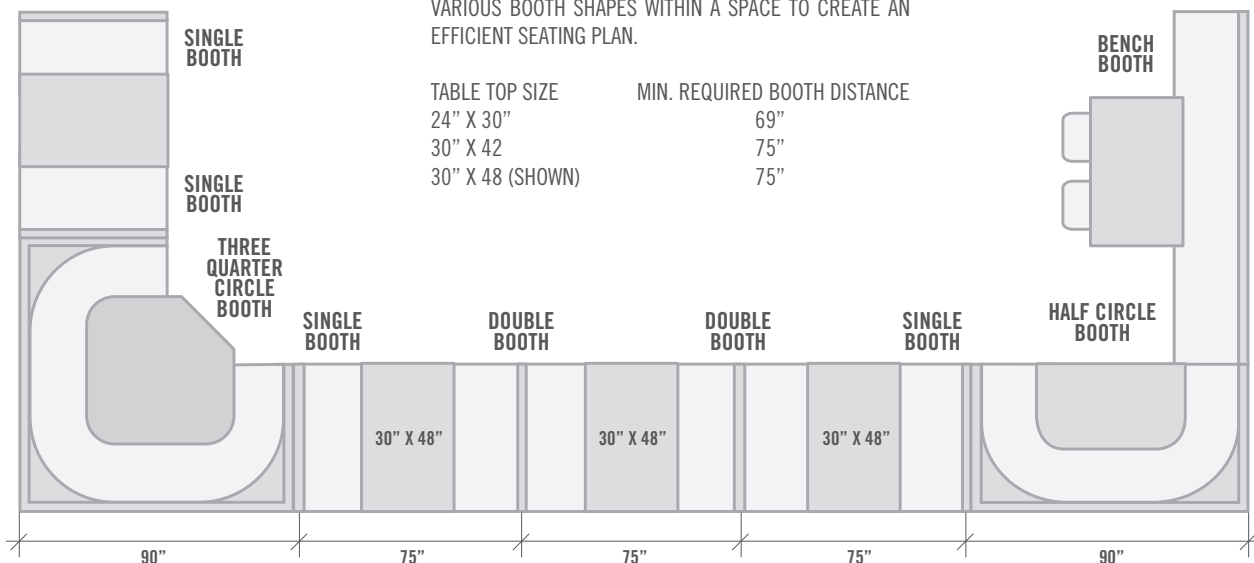

CONSTRUCTION

THE DIFFERENCE IS IN THE DETAILS.

BOOTH SEAT AND BACK
 OUR BOOTHS USE OUR OWN 200K DOUBLE-RUB COMMERCIAL GRADE VINYL WHEN POSSIBLE, OR SIMILAR MATERIALS TO ENSURE STRONG WEAR RESISTANCE



BOOTH INTERIOR
 3/4" PLYWOOD IS USED FOR ALL INTERNAL PARTS OF THE BOOTH; THE SIDES, MIDDLE SUPPORT, BACK, BASE FRAME, AND MULTIPLE CORNER BRACES



BOOTH SEAT
 CONSTRUCTION PHOTO SHOWING THE BOOTH SEAT ASSEMBLY USING OUR 8 GAUGE STEEL SPRINGS SPACED AT TIGHT INTERVALS AND ATTACHED WITH HEAVY DUTY STEEL "C" CLIPS



BOOTH SEAT
 CONSTRUCTION PHOTO OF THE BOOTH SEAT (SHOWN UPSIDE-DOWN) TO DISPLAY THE MULTI-SUPPORT DESIGN AND INTERNAL STRUCTURE



CURVED BOOTH
 3/4" PLYWOOD BACK VERY TIGHTLY SPACED TOGETHER GIVING THE MUCH NEEDED EXTRA SUPPORT WHERE IT IS NEEDED IN THE CURVED BACK AREA



CURVED BOOTH SEAT
 CONSTRUCTION PHOTO OF THE CURVED BOOTH SEAT SHOWING THE SUPPORT SYSTEM USED FOR THE INTERNAL STRUCTURE PRIOR TO THE ADDITION OF THE SPRINGS AND CLIPS



PROJECT SAMPLES

THE DIFFERENCE IS IN THE DETAILS.

